

Schaltplan

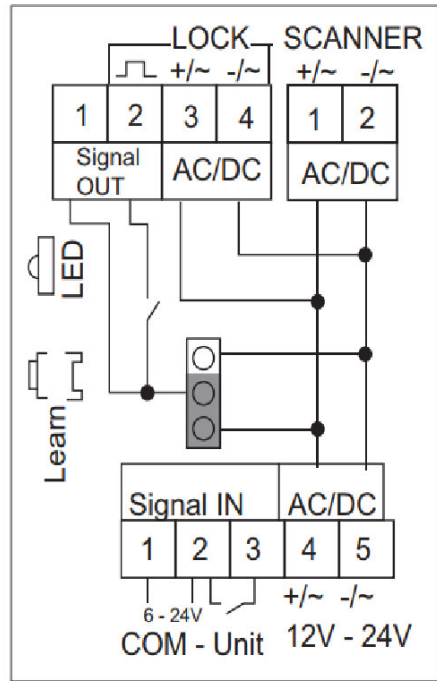

Potentialfrei

Potentialbehaftet
6-24V

2 Motorschloss

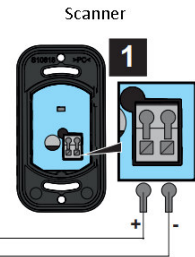
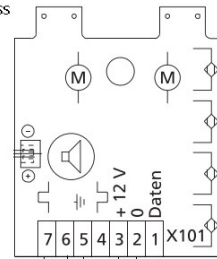

Stößelkontakt

3

Steuerung

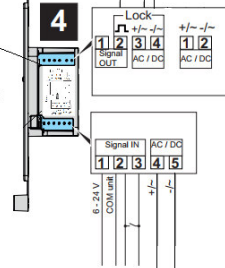

Versorgungsspannung über Schaltnetzteil
min. 12 V DC (Restwelligkeit < 250 mVpp)

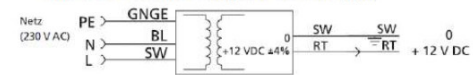

12 V DC

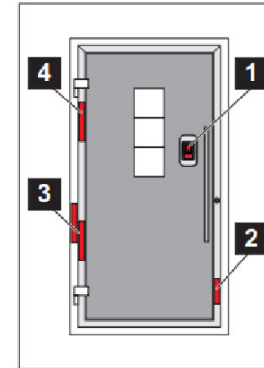
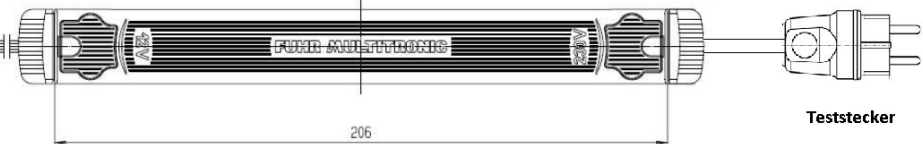

1	Scanner
2	Motorschloss
3	Stößelkontakt
4	Steuerung (Funkempfänger)